



Series
NSX

SIZE 20 CRIMP REMOVABLE PIN CONTACT

Issue:
JANUARY 25 2002

Page
1 / 1

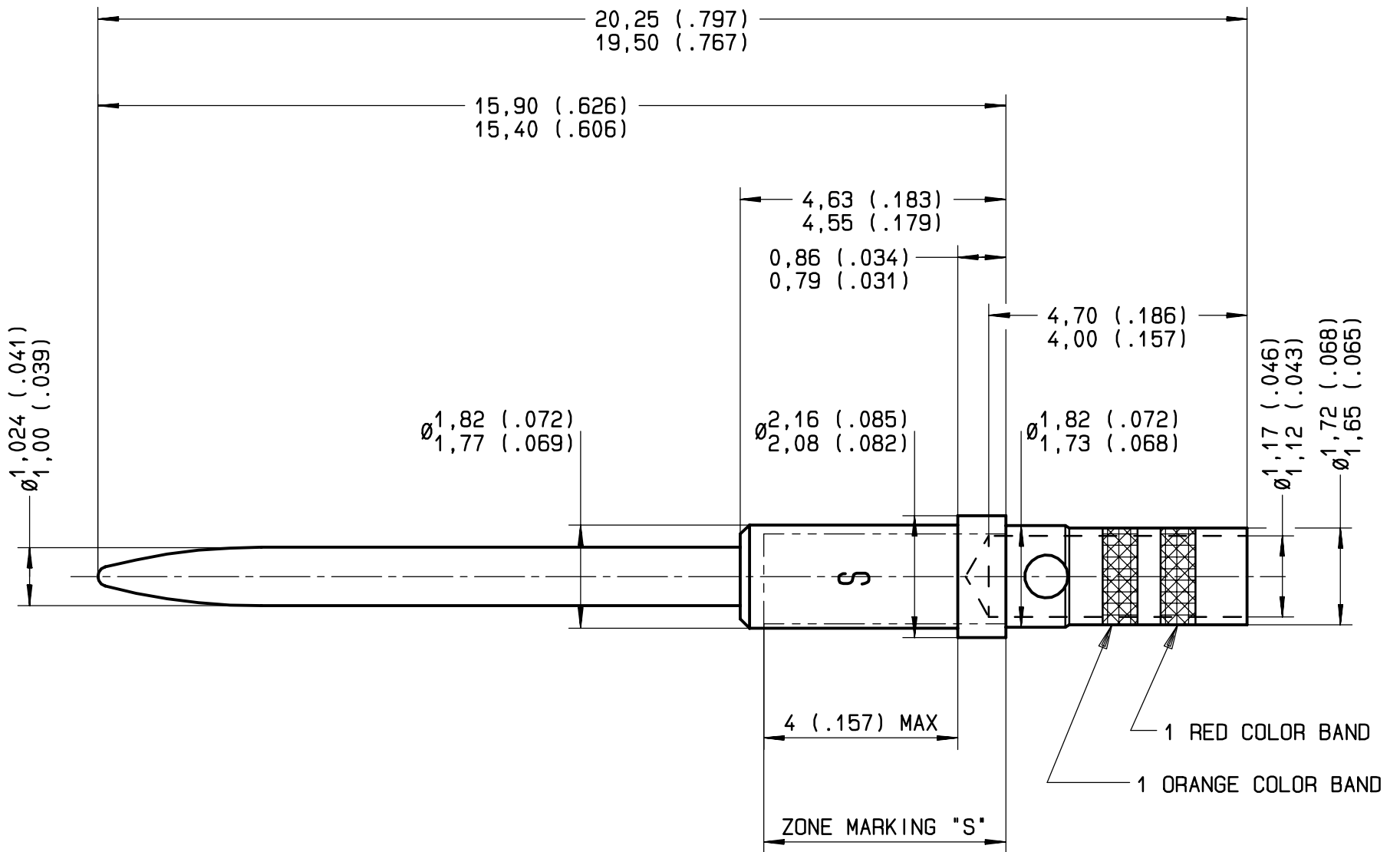

MATERIAL AND FINISH :
COPPER ALLOY - GOLD OVER NICKEL

WIRES ACCOMODATED : AWG 20-22-24
INSULATION DIAMETER : .071 MAX (Ø1,80)
STRIP LENGTH : .158 (4)

TOOLING
CRIMPING TOOL : M22520/2-01 RADIALL 282 281
SELECTOR POSITION : 7 FOR AWG 20
6 FOR AWG 22
5 FOR AWG 24

POSITIONER : M22520/2-08 RADIALL 282 971
INSERTION AND EXTRACTION TOOL : M81969/1-02 RADIALL 282 886

This information is given as an indication. In the continual goal to improve our products, we reserve the right to make any modifications judged necessary.

4112-9311

CREATION				
PEN: .				
NOM: L FALETTI	JAN 25 02	ADD ZONE MARKING "S"	COUTHON	GOMBERT
DATE: 26 APR 83	10 APR 96	DIMENSIONS MODIFIED ACCORDING TO ARINC 600	VALGRESY	BALDYROU
APPR.:	05 APR 96	REDRAWN	VALGRESY	BALDYROU
	Issue	Revisions	Name	Approved