

PT02 (MS3112) SP02 box mounting receptacle

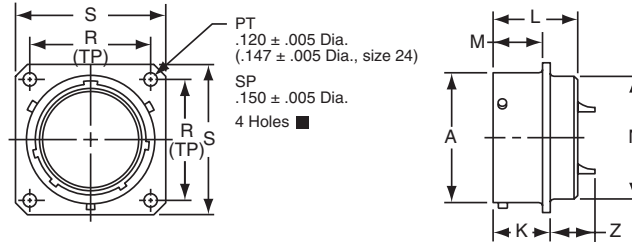

- PT02A-XX-XXX
- SP02A-XX-XXX
- * PT02C-XX-XXX
- * SP02C-XX-XXX
- * PT02E-XX-XXX
- * SP02E-XX-XXX
- MS3112E-XX-XXX
- * PT02P-XX-XXX
- * SP02P-XX-XXX
- MS3112P-XX-XXX
- * PT02W-XX-XXX
- * SP02W-XX-XXX

To complete part number see how to order on page 27.

■ (MMC) located within .0025 of (TP)

* The PT02 and SP02 box mounting receptacles are made only to complete a series; no provision is made for accessories or potting on the rear skirt.

Shell Size	Receptacle Front View				Receptacle Side View								
	R (TP)		S		A +.001 -.005	K +.020 -.010		L Max.	M +.010 -.000		N Dia. Max.	Z Max.	
	PT	SP	PT	SP		PT	SP		PT	SP		PT	SP
6	.469	.641	.688	.953	.348	.493	.524	.825	.431	.462	.323	.465	.438
8	.594	.734	.812	1.047	.473	.493	.524	.825	.431	.462	.449	.465	.438
10	.719	.812	.938	1.125	.590	.493	.524	.825	.431	.462	.573	.465	.438
12	.812	.938	1.031	1.250	.750	.493	.524	.825	.431	.462	.699	.465	.438
14	.906	1.031	1.125	1.344	.875	.493	.524	.825	.431	.462	.823	.465	.438
16	.969	1.125	1.219	1.438	1.000	.493	.524	.825	.431	.462	.949	.465	.438
18	1.062	1.203	1.312	1.516	1.125	.493	.524	.825	.431	.462	1.073	.465	.438
20	1.156	1.297	1.438	1.672	1.250	.650	.650	1.076	.556	.556	1.199	.526	.531
22	1.250	1.375	1.562	1.750	1.375	.650	.650	1.076	.556	.556	1.323	.526	.531
24	1.375	1.500	1.688	1.875	1.500	.683	.683	1.109	.589	.589	1.449	.493	.497

All dimensions for reference only.

Mouser Electronics

Authorized Distributor

Click to View Pricing, Inventory, Delivery & Lifecycle Information:

Amphenol:

[MS3112E12-8PW](#) [MS3112E18-32PY](#) [MS3112E20-41PW](#) [MS3112E22-55PZ](#) [MS3112E24-61PZ](#) [MS3112E10-6P](#)
[MS3112E12-10P](#) [MS3112E8-3P](#) [MS3112E12-8SW](#) [PT02A-12-98P\(027\)](#) [PT02A-16-99P\(027\)](#) [PT02A-16-99S\(027\)](#)
[PT02A-18-30P\(027\)](#) [PT02A-18-30S\(027\)](#) [PT02A-18-32P\(014\)](#) [PT02A-20-24P\(027\)](#) [PT02A-20-24S\(027\)](#) [PT02A-20-](#)
[27P\(027\)](#) [PT02A-20-27S\(027\)](#) [PT02A-20-39P\(027\)](#) [PT02A-20-41P\(027\)](#) [PT02A-22-21P\(027\)](#) [PT02A-22-21S\(027\)](#)
[PT02A-22-32P\(027\)](#) [PT02A-22-32S\(027\)](#) [PT02A-22-34P\(027\)](#) [PT02A-22-34S\(027\)](#) [PT02A-22-36P\(014\)](#) [PT02A-22-](#)
[36P\(027\)](#) [PT02A-22-36S\(014\)](#) [PT02A-22-41P\(027\)](#) [PT02A-24-31P\(027\)](#) [PT02A-24-61P\(027\)](#) [PT02A-8-4P\(014\)](#)
[PT02E-12-10P\(014\)](#) [PT02E-12-10S\(014\)](#) [PT02E-12-3P\(014\)](#) [PT02E-12-3S\(014\)](#) [PT02E-12-8S\(014\)](#) [PT02E-14-](#)
[12S\(014\)](#) [PT02E-14-15S\(014\)](#) [PT02E-14-18P\(014\)](#) [PT02E-14-18S\(014\)](#) [PT02E-14-5P\(014\)](#) [PT02E-14-5S\(014\)](#)
[PT02E-18-32S\(014\)](#) [PT02E-20-16S\(014\)](#) [PT02E-20-41P\(014\)](#) [PT02E-20-41S\(014\)](#) [PT02E-22-32P\(014\)](#) [PT02E-24-](#)
[61P\(025\)](#) [PT02P-20-41P\(027\)](#) [PT02W-14-18P\(027\)](#) [PT02W-16-23P\(027\)](#) [PT02W-20-16P\(027\)](#) [PT02W-20-39P\(027\)](#)
[PT02W-20-41P\(027\)](#) [PT02W-22-34S\(025\)](#) [MS3112E16-26PY](#) [MS3112E18-11SZ](#) [MS3112E18-30P](#) [MS3112E18-30S](#)
[MS3112E12-10SW](#) [MS3112E14-18PZ](#) [MS3112E14-18SZ](#) [MS3112E16-8SW](#) [MS3112E10-98PW](#) [MS3112E14-12PX](#)
[MS3112E14-18PX](#) [MS3112E14-5PW](#) [MS3112E18-32PX](#) [MS3112E18-32SX](#) [MS3112E12-10SY](#) [MS3112E12-10SZ](#)
[MS3112E8-2SW](#) [MS3112E16-26SW](#) [MS3112E22-41PY](#) [MS3112E12-8SX](#) [PT02C10-6S-027](#) [PT02P18-32S-027](#)
[PT02W8-4S-023](#) [MS3112E16-8SX](#) [MS3112E16-8PZ](#) [MS3112E14-18PY](#) [MS3112E20-39SZ](#)